

**APPLICATIONS AND GENERAL CHARACTERISTICS:**

- The seal is made by returning the PVC-U hemisphere thanks to the spring and pressing against a joint of elastomer (EPDM or FPM).
- The valve can work both horizontally and vertically.
- Silent operation.

**TECHNICAL CHARACTERISTICS:**

- Simple union check valves with PVC-U ball. Closure and O-ring of EPDM or FPM according to model. PN (nominal pressure) 16 bars for smooth series and 10 bars threaded series.
- Operating temperature: minimum 0° C and maximum 60° C, decreasing the working pressure according to the indicated in the pressure-temperature diagram on page 10 of our catalog.
- Conformity with the directive CE 97/23 / CE
- Glued connection according to UNE-EN ISO 1452 standard

**COMPONENTS AND MATERIALS:**

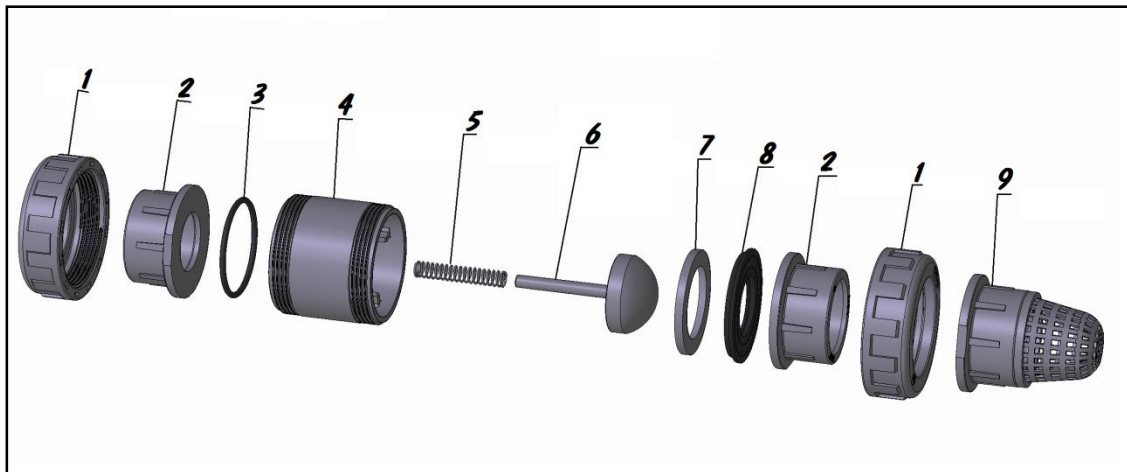

Nº COMPONENT	DESCRIPTION	MATERIAL
1	NUT	PVC-U
2	VALVE END	PVC-U
3	O-RING	EPDM o FPM
4	BODY	PVC-U
5	SPRING	SS AISI 302
6	HEMISPHERE	PVC-U
7	SEAL END	PVC-U
8	SEAL WASHER	EPDM o FPM
9	SCREEN	PVC-U

**DIMENSIONES:**

DIMENSION DOUBLE UNIÓN SPRING CHECK VALVE						
DN	A	B	C	L	ø (lisa)	Peso (kg)
10	30	49	61	96	16	0,118
15	30	49	66	99	20	0,114
20	36	57	68	106	25	0,166
25	46	67	73	117	32	0,243
32	55	81	80	133	40	0,402
40	65	99	84	150	50	0,591
50	80	112	94	170	63	0,866
65	95	154	134	226	75	2,053
65	110	154	141	233	90	2,045

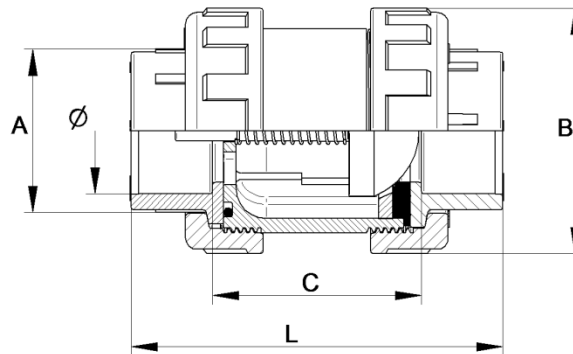

**GRAPH OF HEAD LOSS:**

*Pérdidas de carga de la válvula de retencion de semiesfera.*

